

NOTES:

1. THIS PRELIMINARY GRADING PLAN IS SCHEMATIC ONLY, AND IS INTENDED TO DEPICT THE PROPOSED GENERAL DRAINAGE CONCEPTS AND THE MAGNITUDE OF CUTS AND FILLS. THE FINISHED DESIGN MAY INCORPORATE MINOR REVISIONS DUE TO FINAL DESIGN CONSIDERATIONS.
2. ALL GRADES SHOWN HEREON ARE FINISHED SURFACE GRADES.
3. A RECIPROCAL PARKING AND ACCESS AGREEMENT WILL BE PROVIDED BETWEEN THE PARCELS.
4. ALL IMPROVEMENTS ARE TO CONFORM TO THE CITY OF ROSEVILLE STANDARDS AND NO DEVIATIONS FROM THOSE STANDARDS ARE PROPOSED.
5. EXISTING UTILITIES TO BE REMOVED AS NECESSARY TO ACCOMMODATE LOCATIONS OF PROPOSED BUILDINGS.

ROSEVILLE MERCEDES BENZ SPRINTER VAN

CITY OF ROSEVILLE 1513 EUREKA ROAD CALIFORNIA

PC EXHIBIT F

VICINITY MAP
NOT TO SCALE

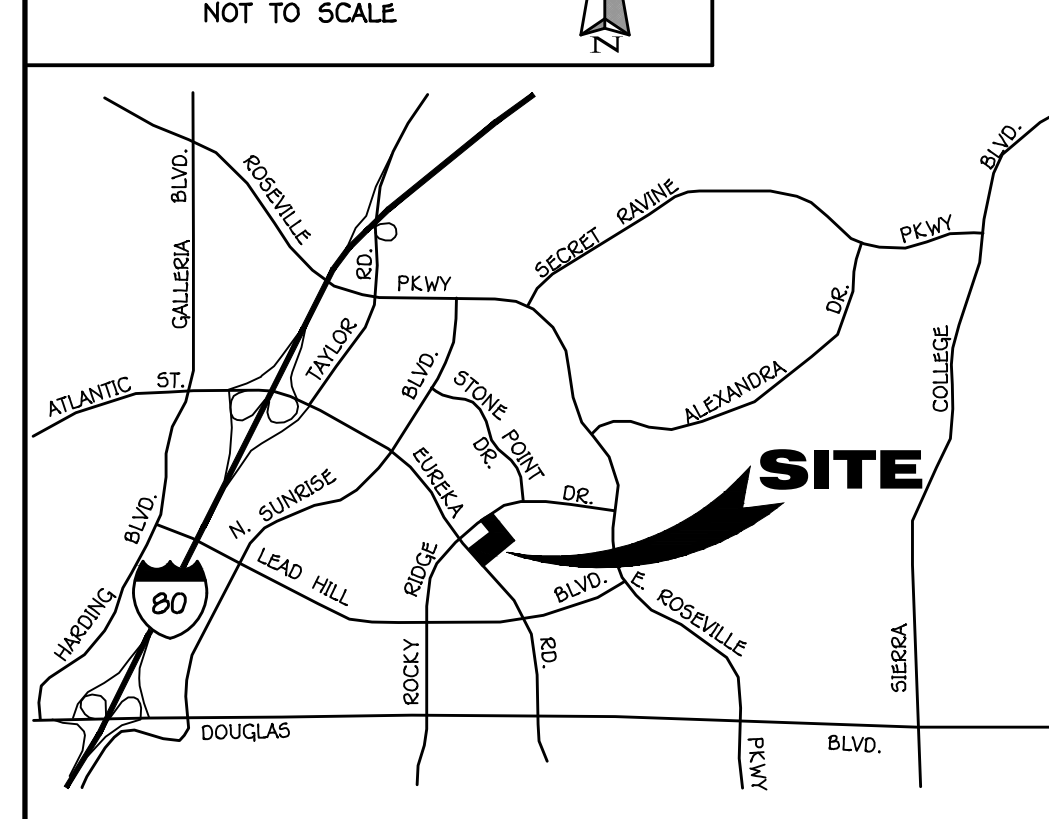

LEGEND

DESCRIPTIONS	(P) PROPOSED	(E) EXISTING
STORM DRAIN	12" D	12" D
SANITARY SEWER	6" S	6" S
WATER MAIN	8" W	8" W
FIRE SERVICE	8" FS	8" FS
CENTERLINE		
RIGHT OF WAY LINE		
BOUNDARY LINE		
ELECTRICAL LINE		
GAS LINE		
TELEPHONE LINE		
JOINT TRENCH	X	X
FENCE	X	X
WOOD FENCE	X	X
WROUGHT IRON FENCE	X	X
WALL		
SIDEWALK WITH CURB AND GUTTER		
VARIABLE CURB FACE		
BARRICADE		
DRIVEWAY		
MANHOLE		
DRAIN INLET		
SEWER CLEANOUT		
WATER SERVICE		
METERED WATER SERVICE		
POST INDICATOR VALVE		
FIRE HYDRANT		
FIRE DEPT. CONNECTION		
BLOWOFF VALVE		
GATE VALVE		
BUTTERFLY VALVE		
REDUCED PRESSURE BACKFLOW PREVENTOR		
DOUBLE DETECTOR		
CHECK VALVE		
TYPE 'A' STREET LIGHT		
TYPE 'B' STREET LIGHT		
TRAFFIC LIGHT		
TRANSFORMER		
PULLBOX		
PEDESTAL & SERVICE CAN		
UTILITY SERVICE PEDESTAL		
UTILITY POLE		
GUY WIRE		
4 SIDED STREET SIGN		
SIGN		
RIDGE LINE		
DIRECTION OF FLOW		
FLOWLINE		
SWALE		
PAD ELEVATION	000.0	000.0
ELEVATION	123.45	123.45
2:1 SLOPE UNLESS NOTED OTHERWISE		
TREE TO BE REMOVED		
TREE TO REMAIN, CONSTRUCT TEMPORARY FENCE		

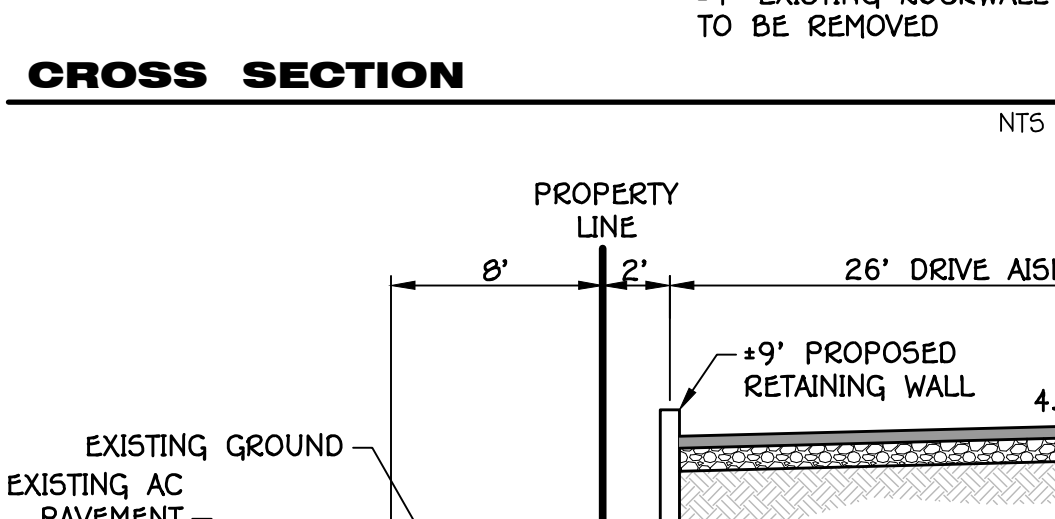
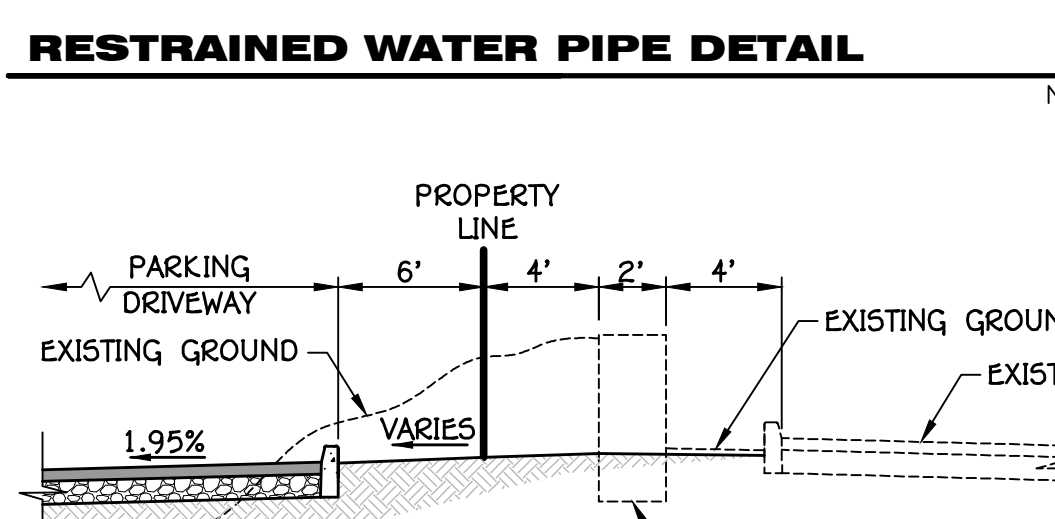
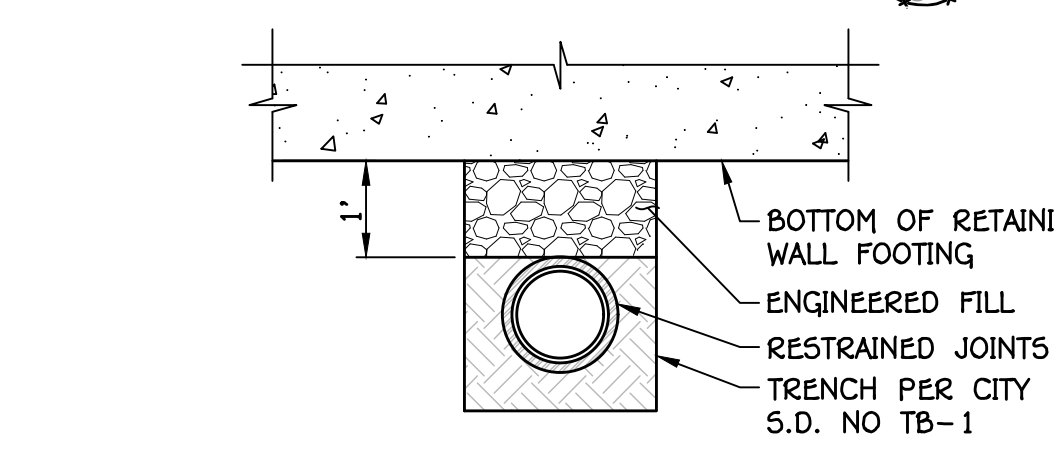
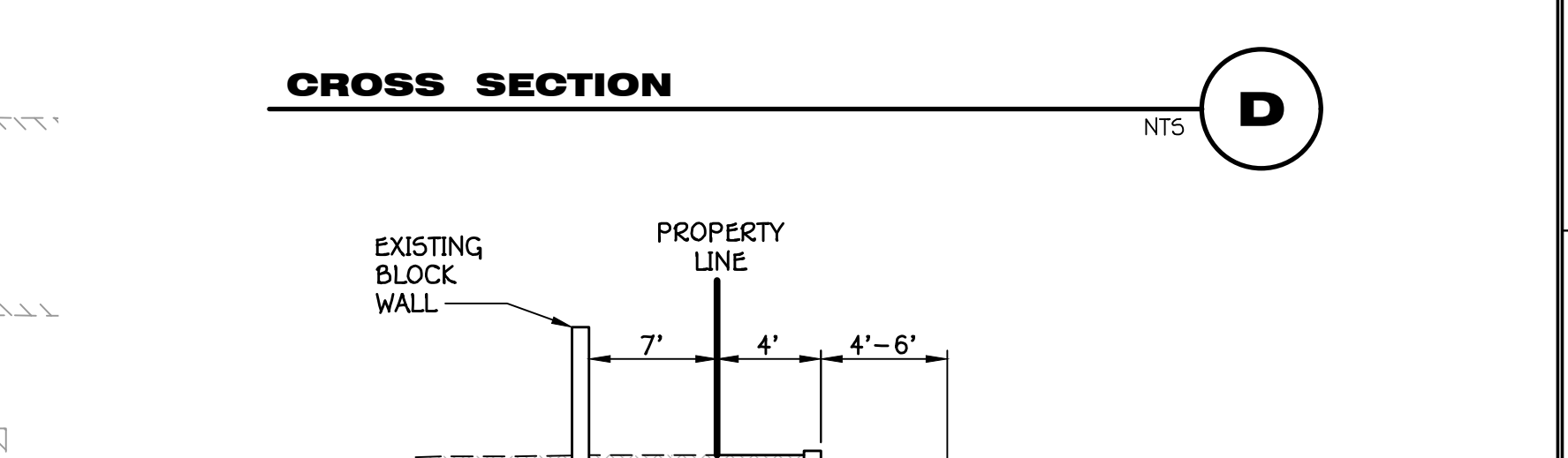
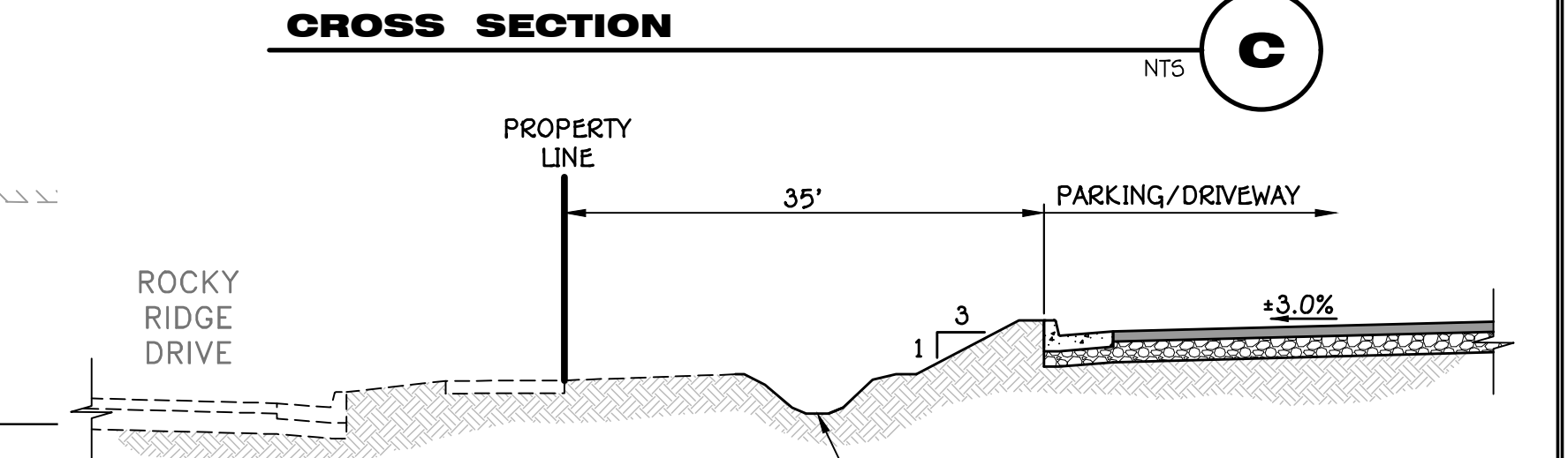
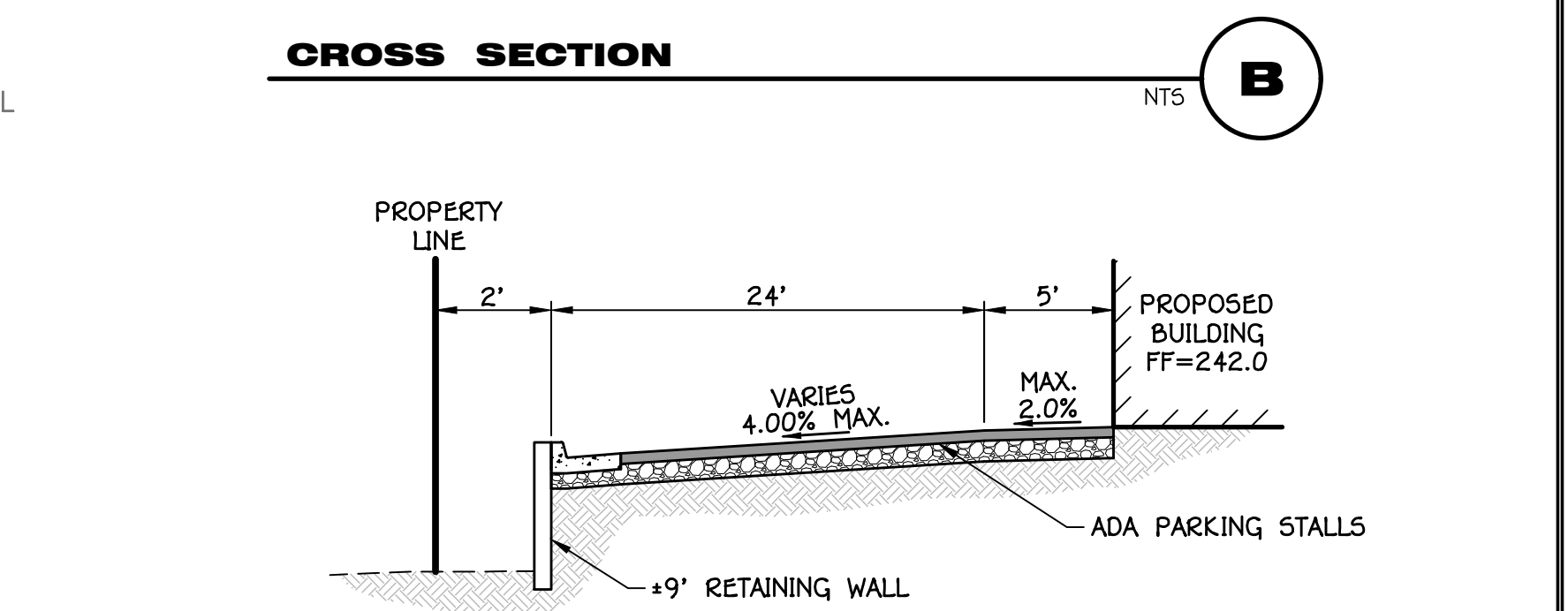
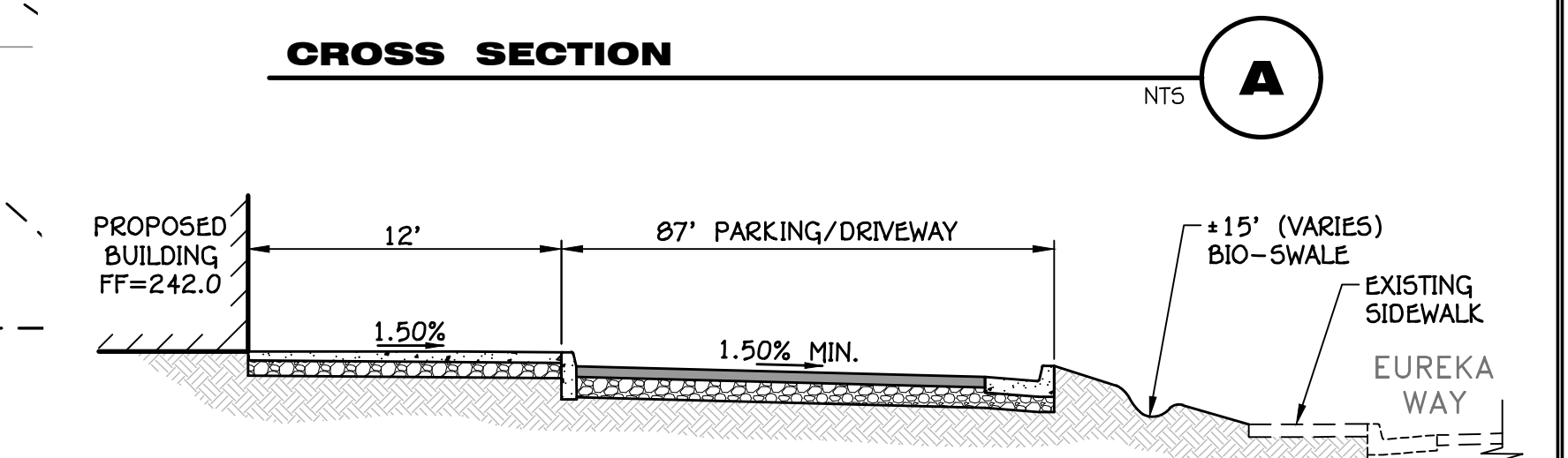
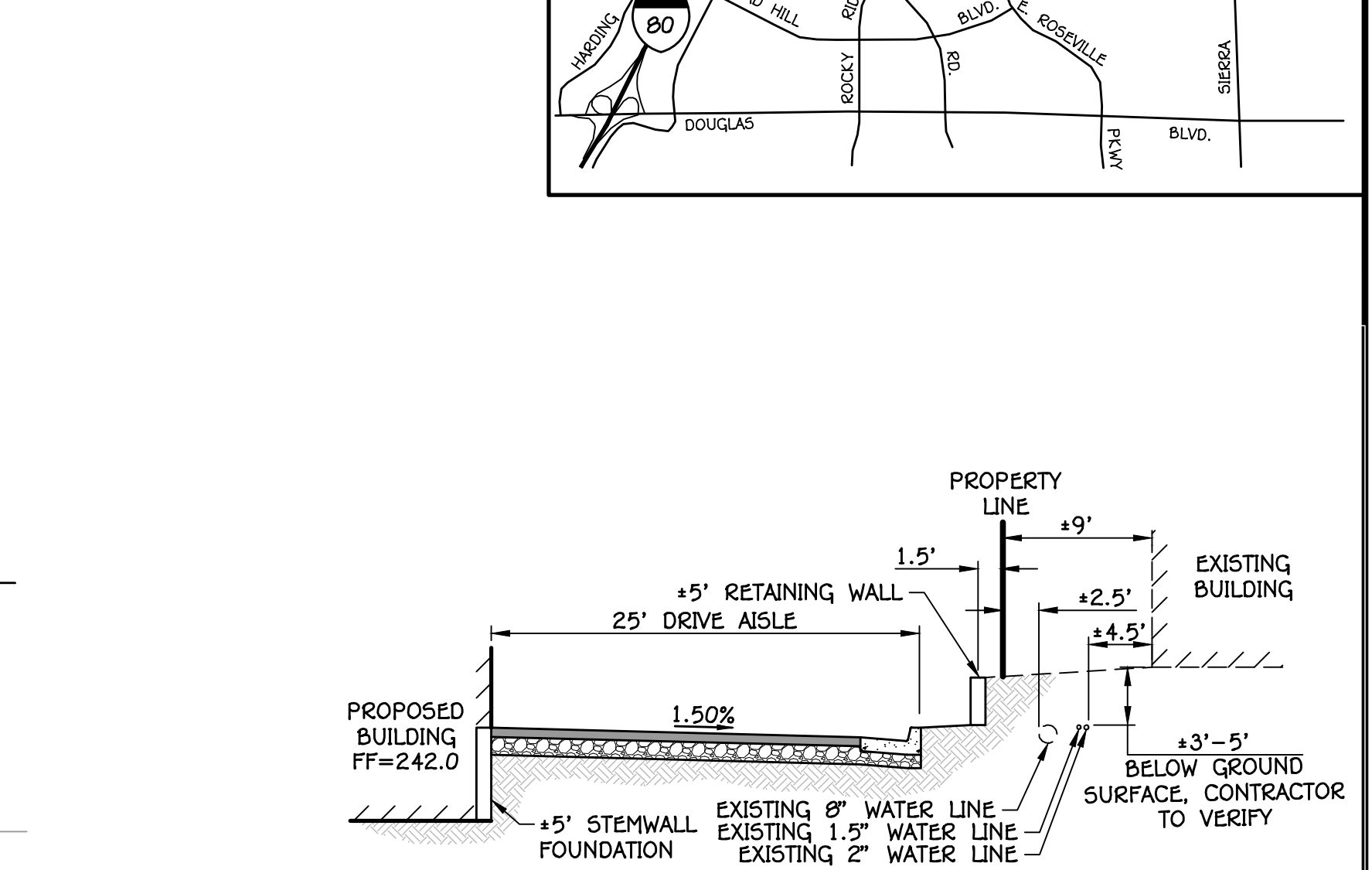
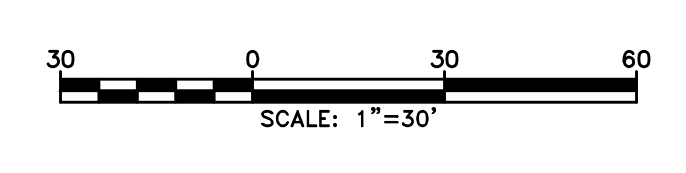
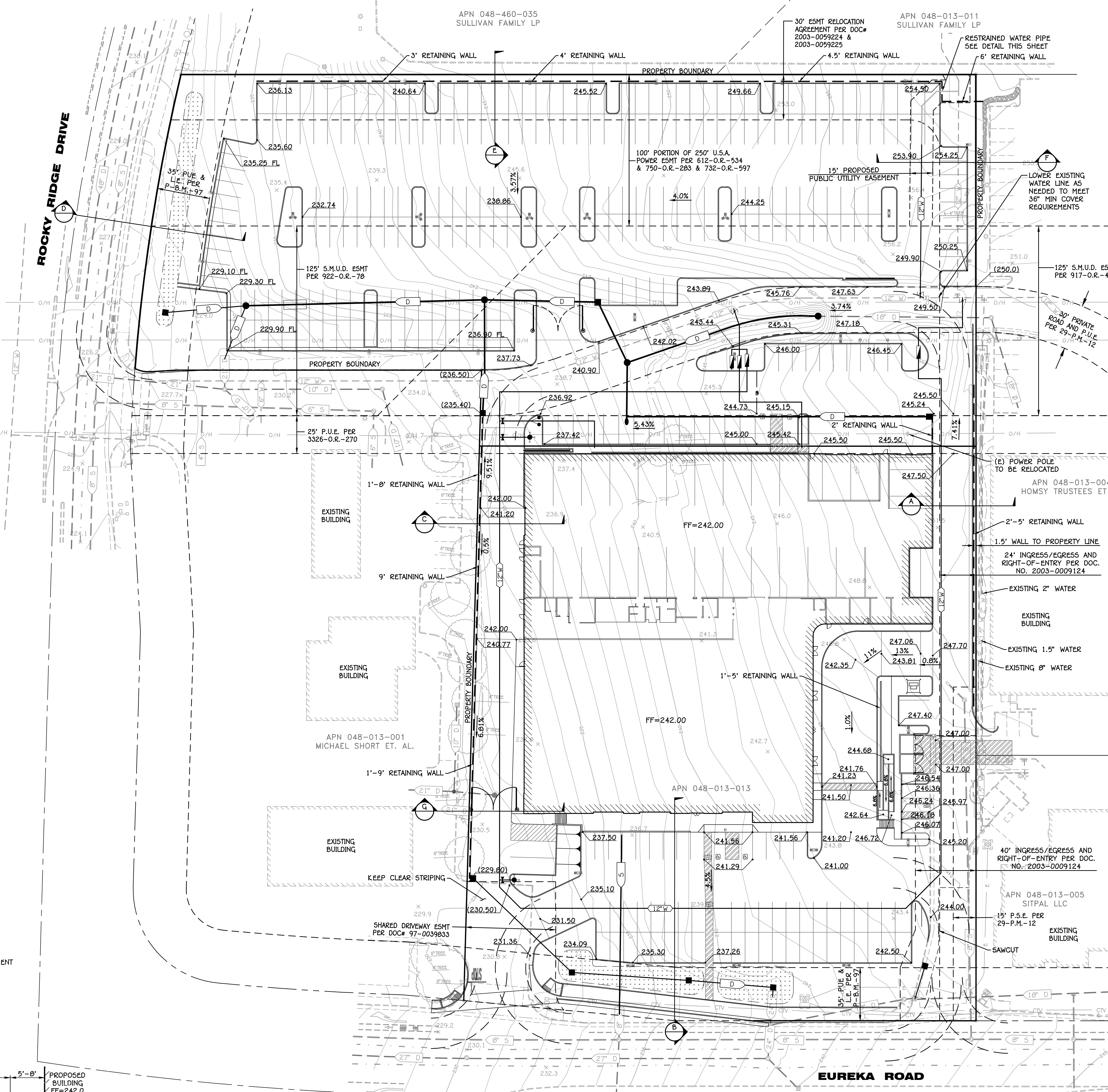

**PRELIMINARY GRADING AND UTILITY PLAN FOR:
ROSEVILLE MERCEDES BENZ SPRINTER VAN
1513 EUREKA ROAD
AUGUST 17, 2023**

BURRELL CONSULTING GROUP, INC. 1001 Enterprise Way, Suite 100 Roseville, CA 95678 (916) 783-8898
 PROJECT NO. 2023-009124
 DATE: AUGUST 17, 2023
 DRAWN BY: [Name]
 CHECKED BY: [Name]
 APPROVED BY: [Name]
 SCALE: AS SHOWN
 SHEET NO. 1 OF 1
 ALL RIGHTS RESERVED. NO PART OF THIS DOCUMENT IS TO BE REPRODUCED OR TRANSMITTED IN ANY FORM OR BY ANY MEANS, ELECTRONIC OR MECHANICAL, WITHOUT PERMISSION IN WRITING FROM BURRELL CONSULTING GROUP, INC.