

SHEET NOTES

1. THE CONTRACTOR SHALL VERIFY THE LOCATION OF UNDERGROUND UTILITIES AND REPORT ANY CONFLICTS TO THE LANDSCAPE ARCHITECT FOR DECISION PRIOR TO COMMENCING CONSTRUCTION.  
2. SEE SHEET L2.01 FOR MATERIAL SCHEDULE.  
3. SEE CIVIL DRAWINGS FOR ROADWAYS, CURB AND GUTTER, STRIPING, SIGNAGE, AND ADA ACCESSIBLE CURB RAMPS.

KEYNOTE

- 1 COLUMNS, SEE ARCHITECTURAL DRAWING  
2 SCREEN WALL, SEE ARCHITECTURAL DRAWING  
3 REPLACE IN KIND

LEGEND

- LIMIT OF WORK
- CIP-P1 CAST-IN-PLACE CONCRETE - PEDESTRIAN, TYPE 1
- CIP-P2 CAST-IN-PLACE CONCRETE - PEDESTRIAN, TYPE 2
- CUP-P CONCRETE UNIT PAVING - PEDESTRIAN CONDITION
- ED CONCRETE EDGING
- BO K-RATED BOLLARD
- BR BIKE RACK
- BN BENCH
- TB-1 OUTDOOR TABLE SET - TYPE 1
- TB-2 OUTDOOR TABLE SET - TYPE 2
- SW CUSTOM SEATWALL

No.	Revision Description	YYYY-MM-DD
1	MPP STAGE 2	2022-05-25
1	MPP STAGE 2 RESPONSE	2022-06-30
	MPP STAGE 2 RESPONSE 2	2022-08-19

Agency Approval

Key Plan



Hellmuth, Obata + Kassabaum, Inc.  
One Bush Street, Suite 200  
San Francisco, CA 94104 USA  
t +1 415 243 0555 f +1 415 882 7763

All reproduction & intellectual property  
rights reserved © 2021

BKF ENGINEERS  
Civil Engineering  
880 9th St, Suite 2300  
Sacramento, CA 95814

Professional Seals

NOT FOR  
CONSTRUCTION

Facility  
KAISER PERMANENTE  
ROSEVILLE MEDICAL  
CENTER  
ROSEVILLE, CALIFORNIA  
Project  
INPATIENT BED TOWER  
1600 EUREKA RD  
ROSEVILLE, CA 95661

Sheet Title  
MATERIAL & FURNISHING  
PLAN

Scale:	Kaiser Project # CAP015954
As indicated	HOK Project # 17.04047.00
Date:	Sheet Number
08/19/22	L1.03

Original drawing is 42 x 30. Do not scale contents of this drawing.

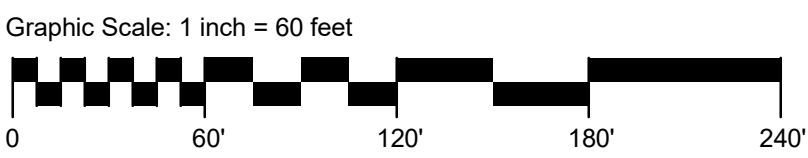





NATIONAL FACILITIES SERVICES  
POST OFFICE BOX 12916  
OAKLAND, CA 94604

Agency Approva

### Key Plan

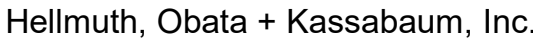

All reproduction & intellectual property  
rights reserved © 2024

Professional Seals

Project  
INPATIENT BED TOWER  
1600 EUREKA RD  
ROSEVILLE, CA 95661

Original drawing is 42 x 30. Do not scale contents of this drawing

FURNITURE SCHEDULE - TOWER					
SYMBOL/ ABBREVIATION	ELEMENTS	MATERIAL PROFILE	NOTES	MANUFACTURER	MOCKUP
BN.	BENCH - ESCOFET ABRIL CONCRETE BENCH - BACKLESS	CONCRETE BASE	ACID-ETCHED FINISH, COLOR: WHITE	LANDSCAPE FORMS	
BO	K-RATED BOLLARD	HELIO SECURITY BOLLARD 40" X 9.25" DIA STAINLESS STEEL TUBE AND HEAD CAP MOUNT: 30" EMBEDDED MOUNT STRUCTURAL FOOTING MINIMUM SIZE: 56"x56"W X 60"DEEP	MODEL: 900 SERIES - M30/K4, NON-ILLUMINATED FINISH: #4 SATIN -	FORMS AND SURFACES	
BR	BIKE RACK - 35 COLLECTION - LOOP	CAST ALUMINUM RIBBON FRAME	POWDERCOATED, COLOR: METALLIC SILVER, EMBEDDED TO CONCRETE SURFACE -	LANDSCAPE FORMS	
SW	CUSTOM SEATWALL	GALV. STEEL RESTRAINT STRAP PRECAST CONCRETE CONCRETE BASE AGGREGATE BASE	MISSION WHITE, CRAFTSMAN'S ETCH FINISH - REFER TO STRUCTURAL DRAWINGS REFER TO CIVIL DRAWINGS	QCP	YES
TB-1	OUTDOOR TABLE SET - TYPE 1	CAROUSEL TABLE WITH 4 FIXED BACKLESS SEATING UMBRELLA	COLOR: FLAMBE ORANGE, POWDERCOATED METAL (GLOSS) COLOR: WHITE, FABRIC SPECIFIED BY MANUFACTURER	LANDSCAPE FORMS	
TB-2	OUTDOOR TABLE SET - TYPE 2	GROVE TABLE (1) GROOVE BENCHES - BACKLESS (2)	PRECAST CONCRETE, SANDSTONE FINISH, COLOR: MISSION WHITE PRECAST CONCRETE, SANDSTONE FINISH, COLOR: MISSION WHITE	QCP	





KAISER PERMANENTE  
KAISER FOUNDATION  
HEALTH PLAN INC

NATIONAL FACILITIES SERVICES  
POST OFFICE BOX 12916  
OAKLAND, CA 94604

[illegible]

Agency Approval

### Key Plan

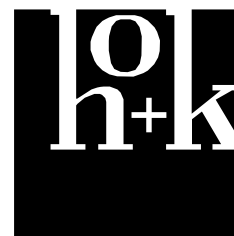

Hellmuth, Obata + Kassabaum, Inc.

One Bush Street, Suite 200  
San Francisco, CA 94104 USA  
t +1 415 243 0555 f +1 415 882 7763

All reproduction & intellectual property  
rights reserved © 2004

**BKF ENGINEERS**  
Civil Engineering  
980 9th St, Suite 23  
Sacramento, CA 95811

Professional Seals

NOT FOR  
CONSTRUCTION

Facility  
KAISER PERMANENTE  
ROSEVILLE MEDICAL  
CENTER  
ROSEVILLE, CALIFORNIA

Project  
INPATIENT BED TOWER  
1600 EUREKA RD  
ROSEVILLE, CA 95661

Sheet Title  
ENLARGED DETAILS -  
SEATWALL

Scale:	Kaiser Project # CAP015954
	HOK Project # 17.04047.00
	Sheet Number
Date:	L4.01
08/19/22	

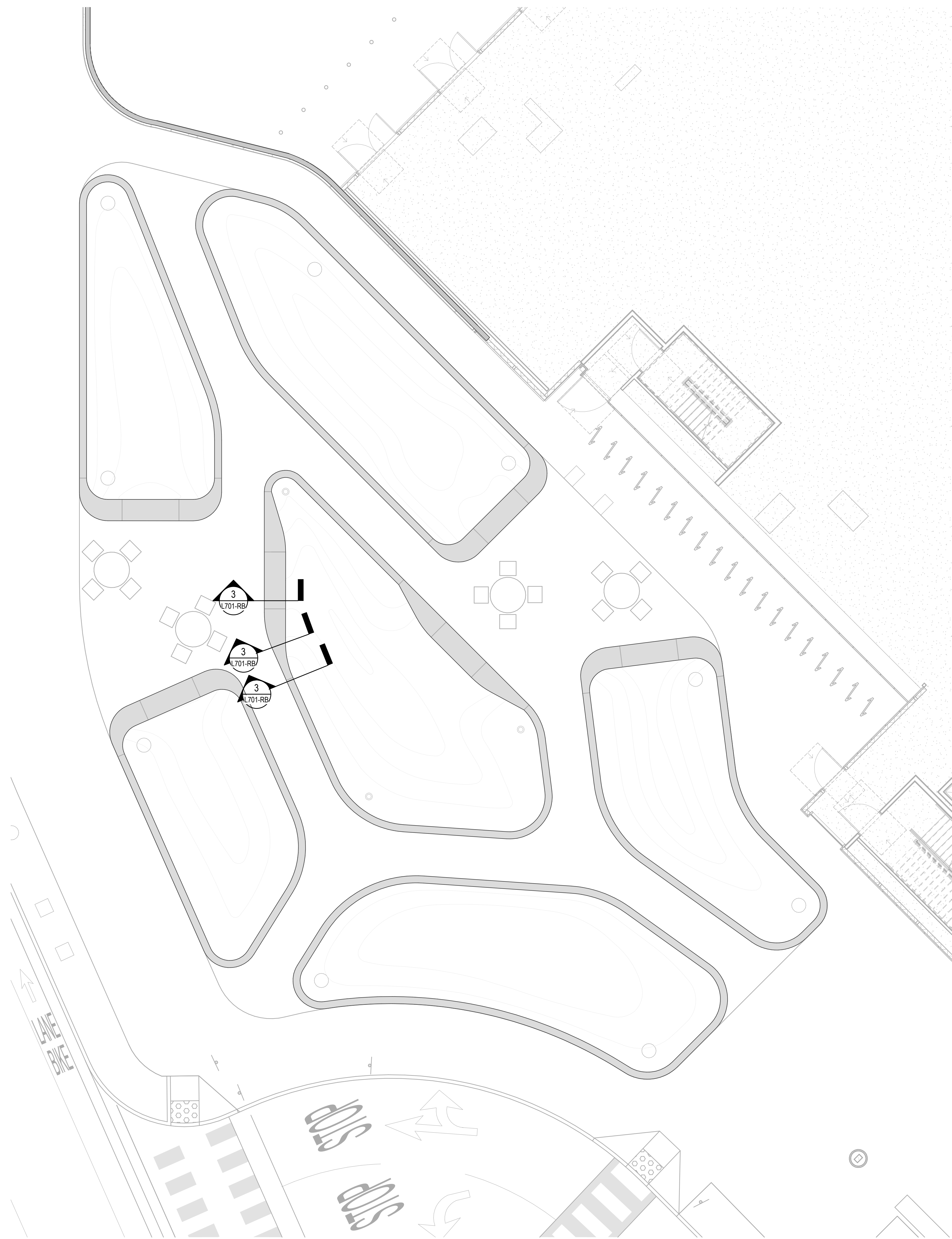

2 ENLARGEMENT PLAN - CUSTOM SEATWALL - TOWER  
1/8" = 1'-0"

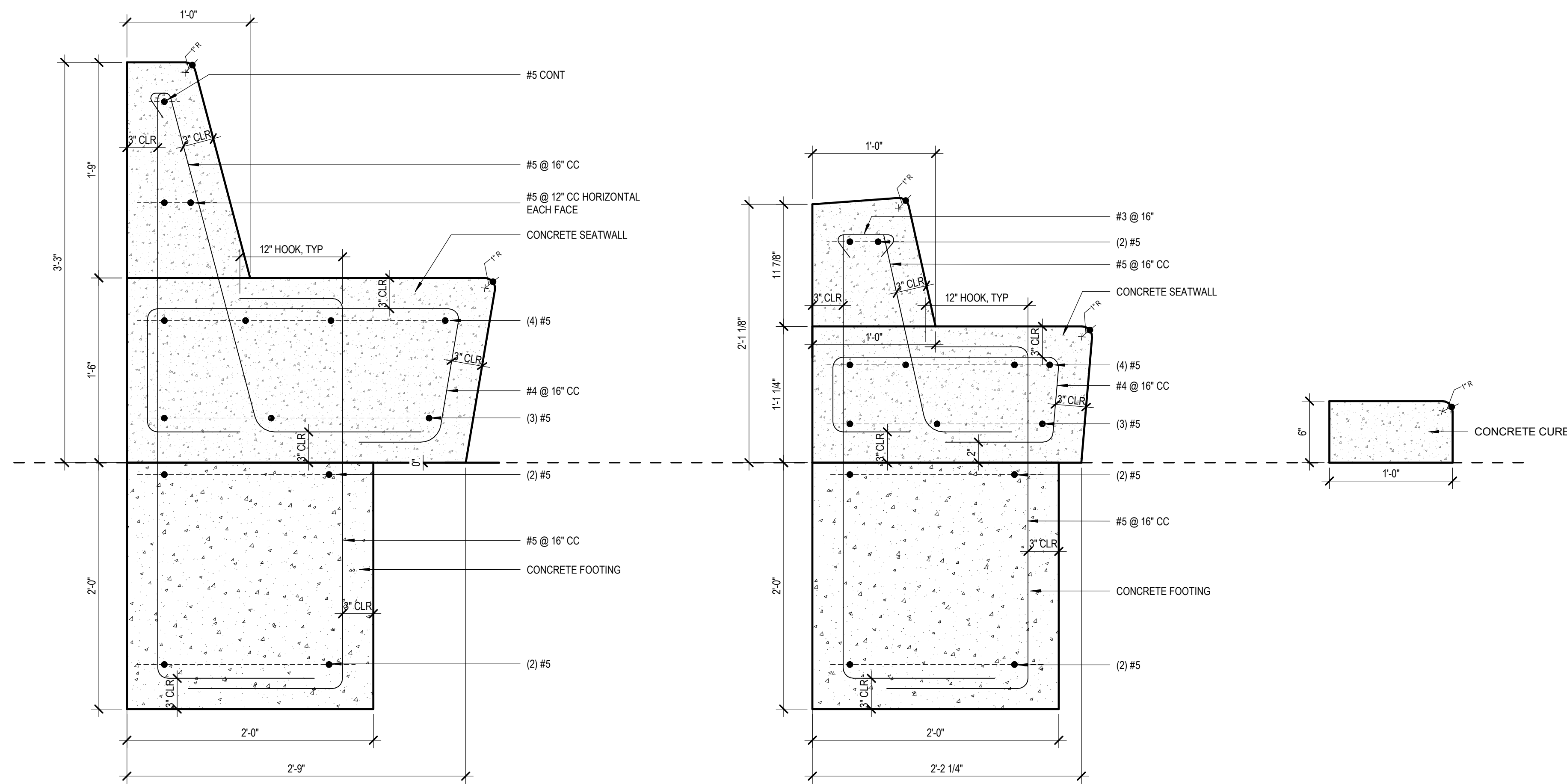

### 3 CUSTOM SEATWALL - SECTIONS - TOWER

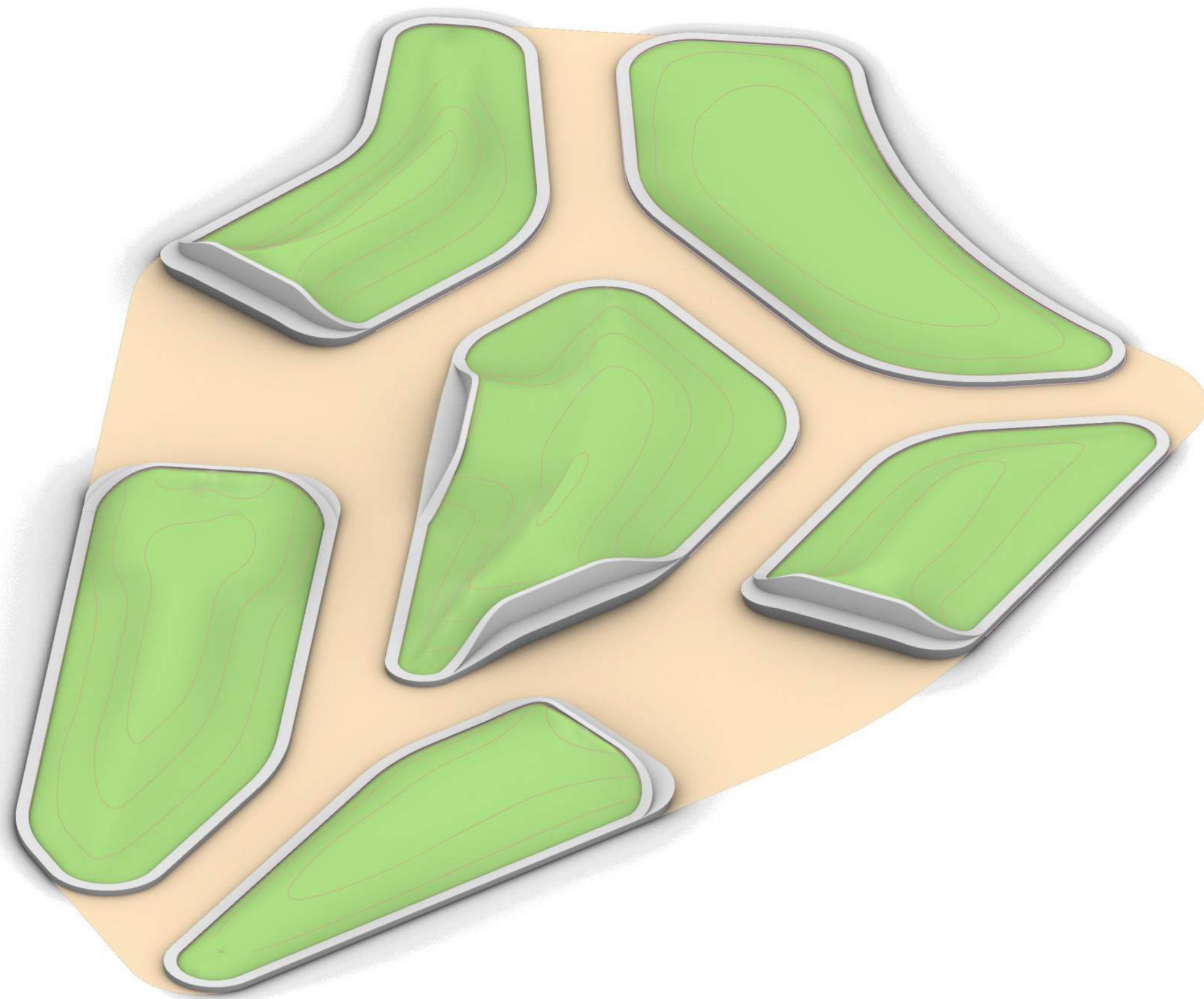

1 CUSTOM SEATWALL - AXON - TOWER  
3/8" = 1'-0"



2022-08-29 2:16:40 PM

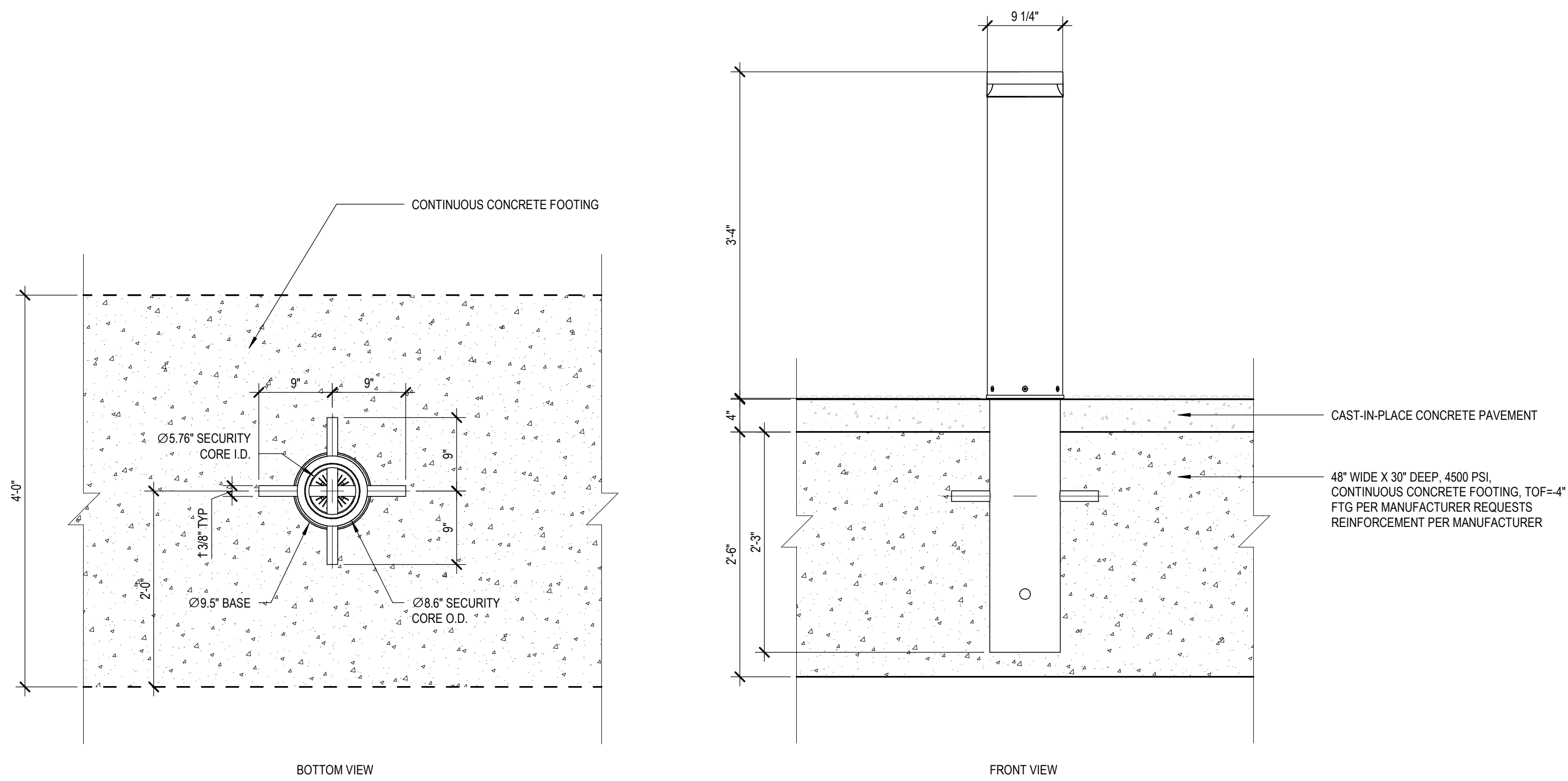

6 K-RATED BOLLARD (BO) - TOWER  
1" = 1'-0"

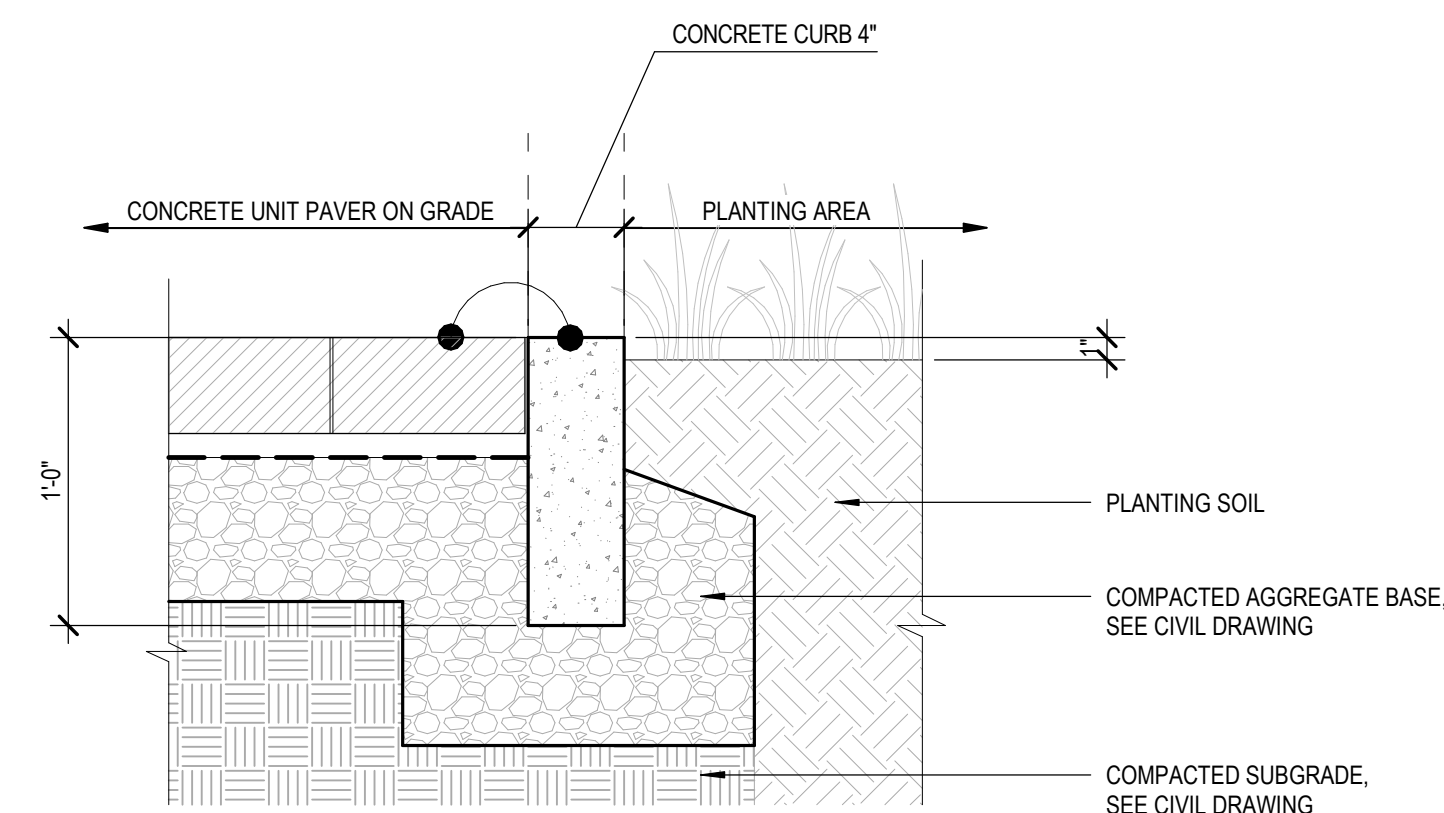

5 CONCRETE EDGING (ED) - TOWER  
1 1/2" = 1'-0"

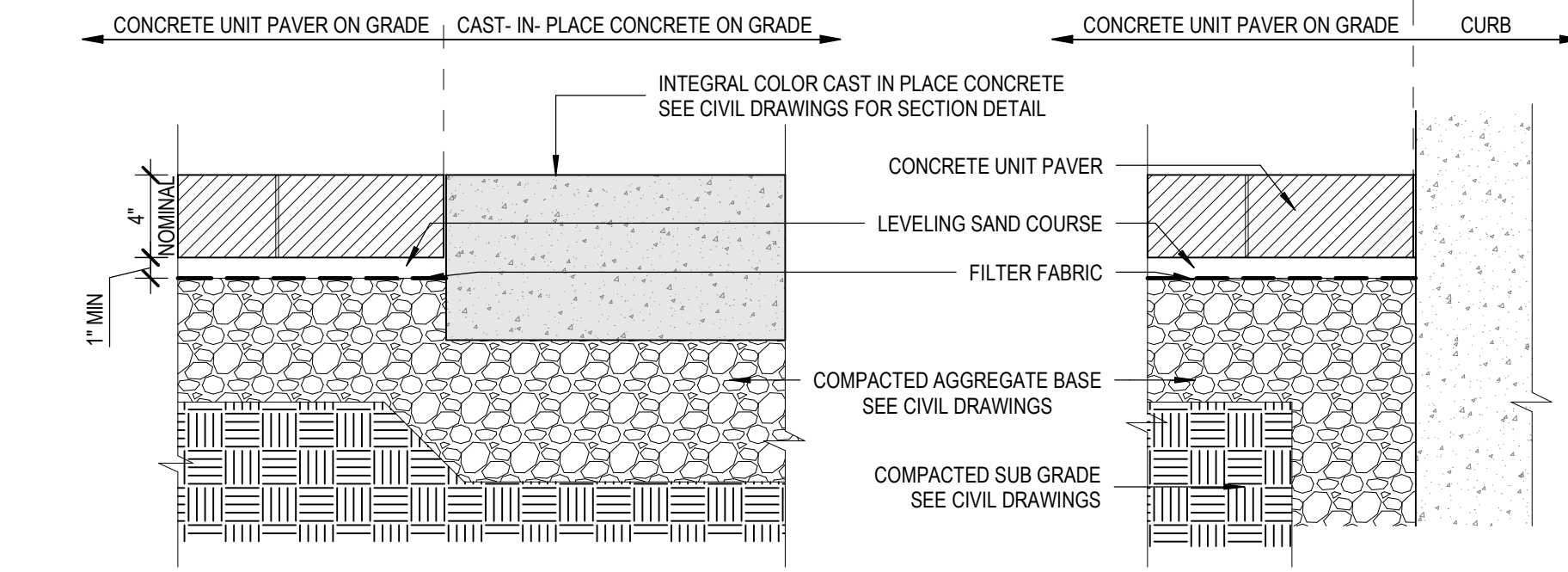

4 CONCRETE UNIT PAVING - VEHICULAR  
CONDITION (CUP-V) - TOWER  
1 1/2" = 1'-0"

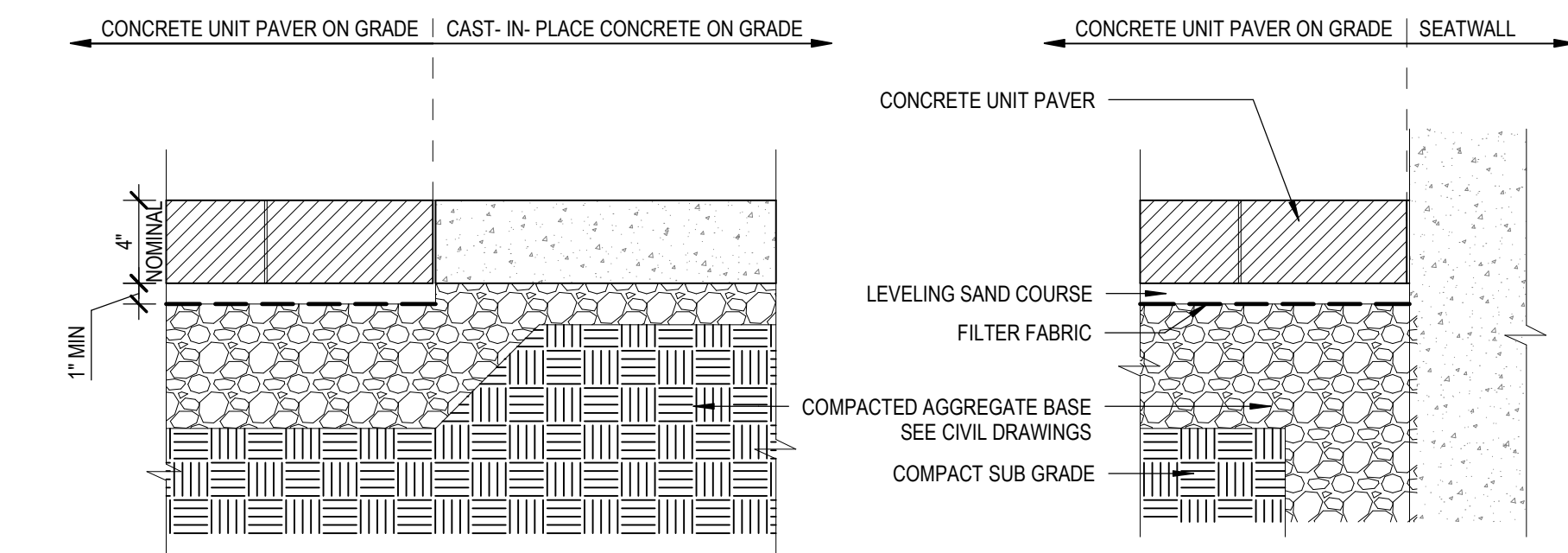

3 CONCRETE UNIT PAVING - PEDESTRIAN  
CONDITION (CUP-P) - TOWER  
1 1/2" = 1'-0"

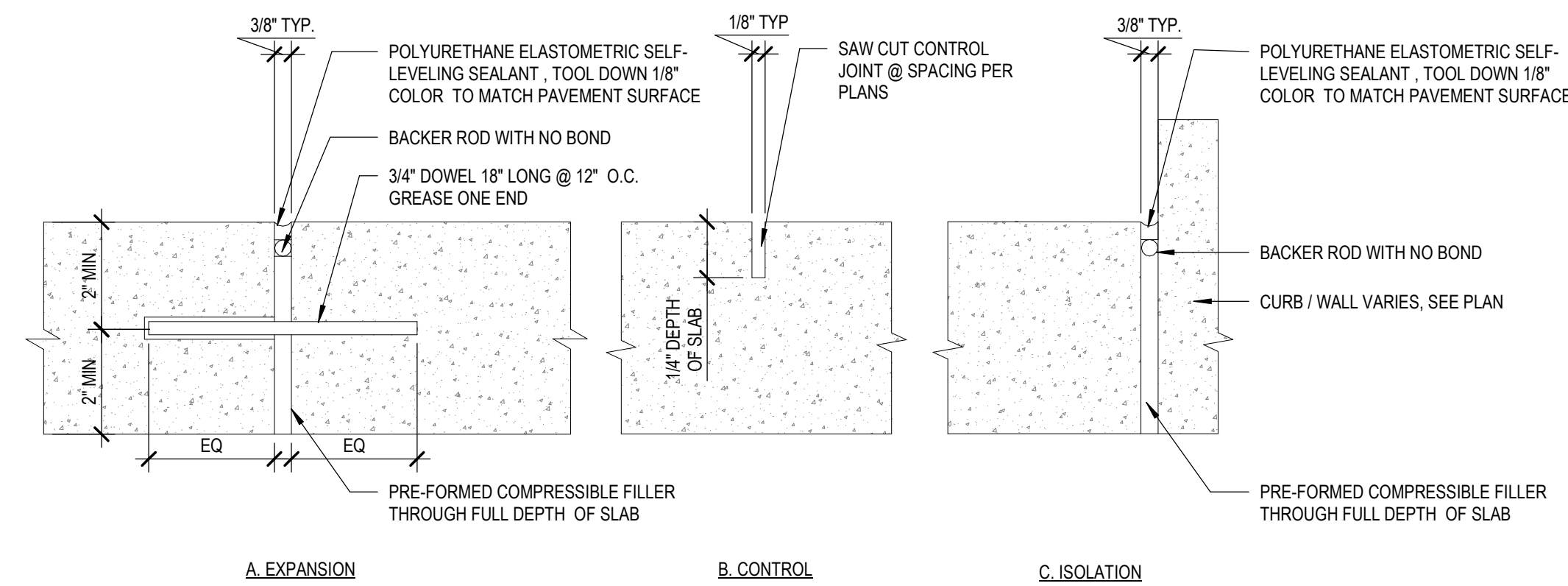

2 CONCRETE PAVING JOINTS - TOWER  
3" = 1'-0"

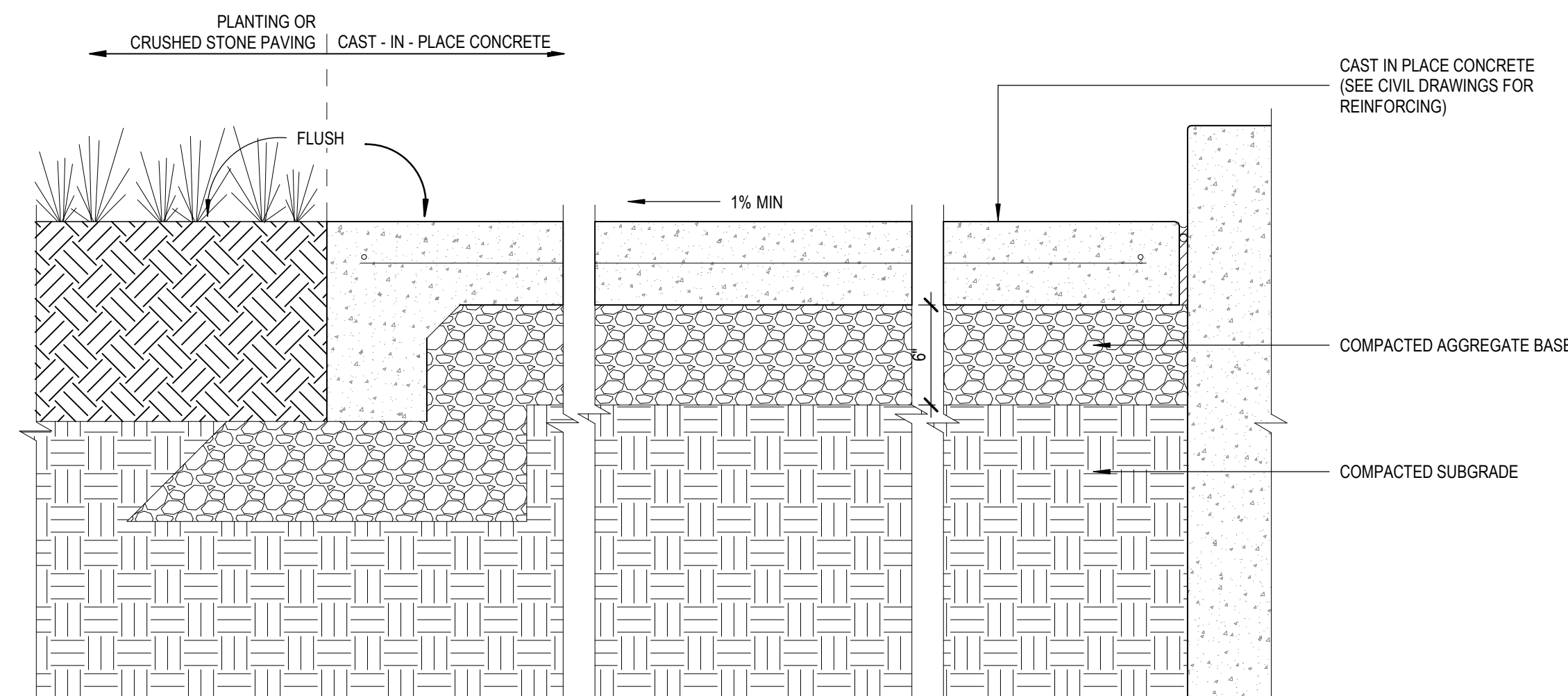

1 CAST-IN-PLACE CONCRETE PAVING -  
PEDESTRIAN CONDITION (CIP-P1 & P2) -  
TOWER  
1 1/2" = 1'-0"

No.	Revision Description	YYYY-MM-DD
1	MPP STAGE 2	2022-05-25
1	MPP STAGE 2 RESPONSE	2022-06-30
1	MPP STAGE 2 RESPONSE 2	2022-08-19

Agency Approval

Key Plan

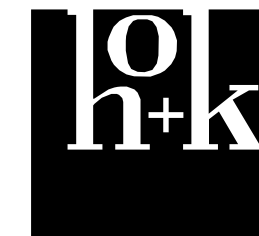

Hellmuth, Obata + Kassabaum, Inc.

One Bush Street, Suite 200  
San Francisco, CA 94104 USA  
t +1 415 243 0555 f +1 415 882 7763

All reproduction & intellectual property  
rights reserved © 2021

BKF ENGINEERS  
Civil Engineering  
880 9th St, Suite 2300  
Sacramento, CA 95814

Professional Seals

NOT FOR  
CONSTRUCTION

Facility  
KAISER PERMANENTE  
ROSEVILLE MEDICAL  
CENTER  
ROSEVILLE, CALIFORNIA  
Project  
INPATIENT BED TOWER  
1600 EUREKA RD  
ROSEVILLE, CA 95661

Sheet Title  
MATERIAL & FURNISHING  
DETAILS

Scale:	Kaiser Project # CAP015954 HOK Project # 17.04047.00 Sheet Number
Date: 08/19/22	L4.11

Original drawing is 42 x 30. Do not scale contents of this drawing.

2022-08-29 2:16:42 PM

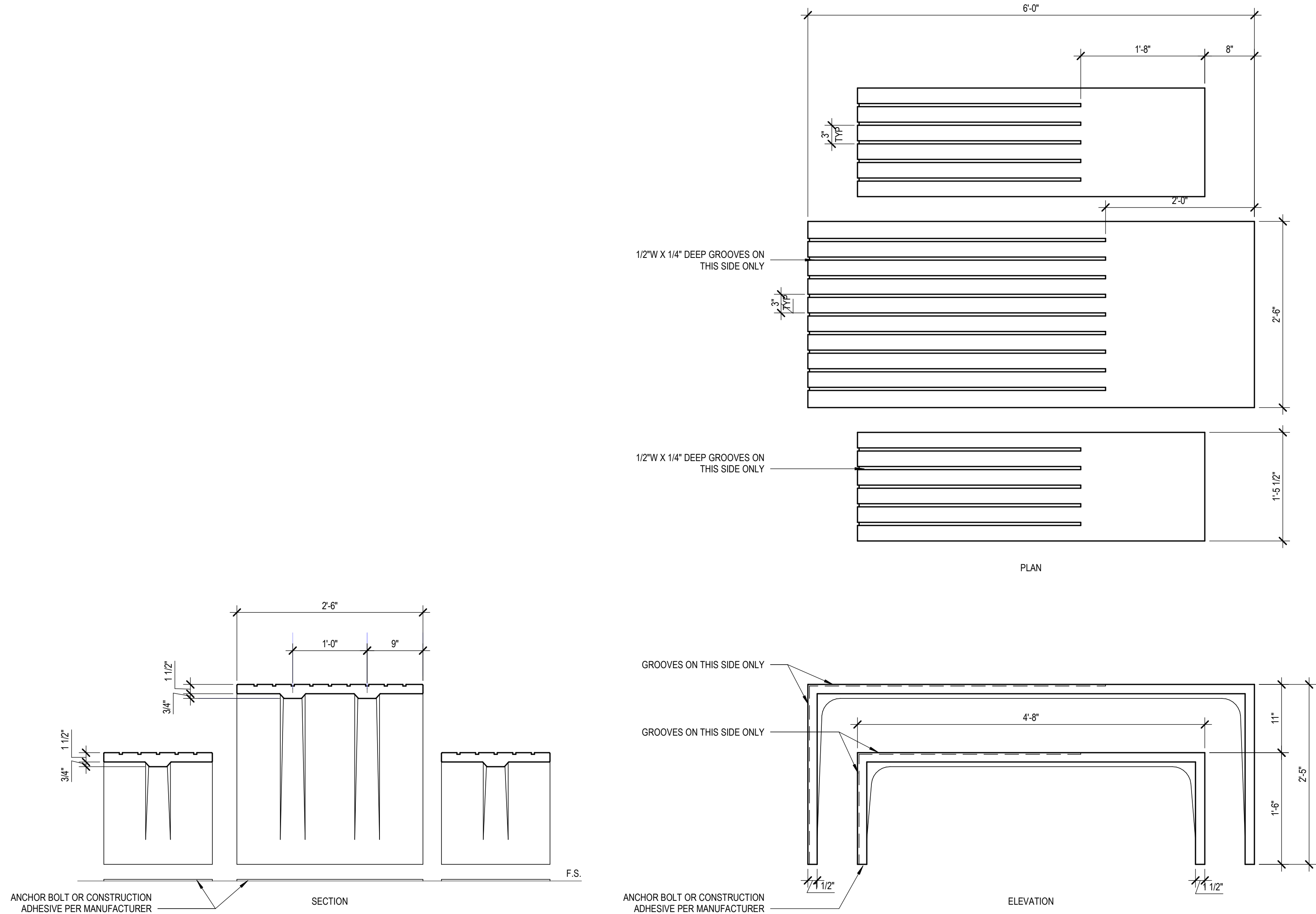

4 TABLE SET - TYPE 2 (TB-2) - TOWER  
1" = 1'-0"

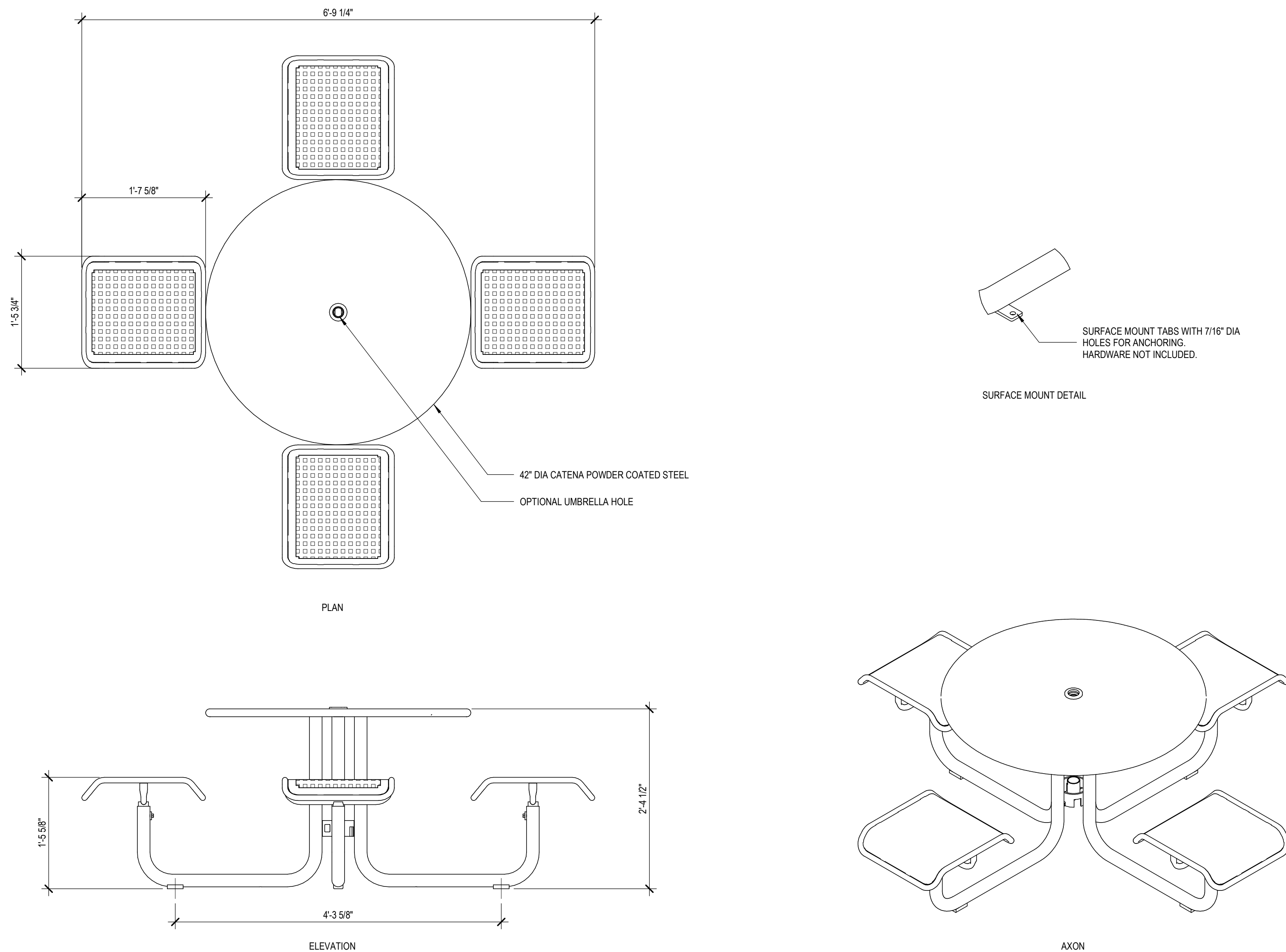

3 TABLE SET - TYPE 1 (TB-1) - TOWER  
1" = 1'-0"

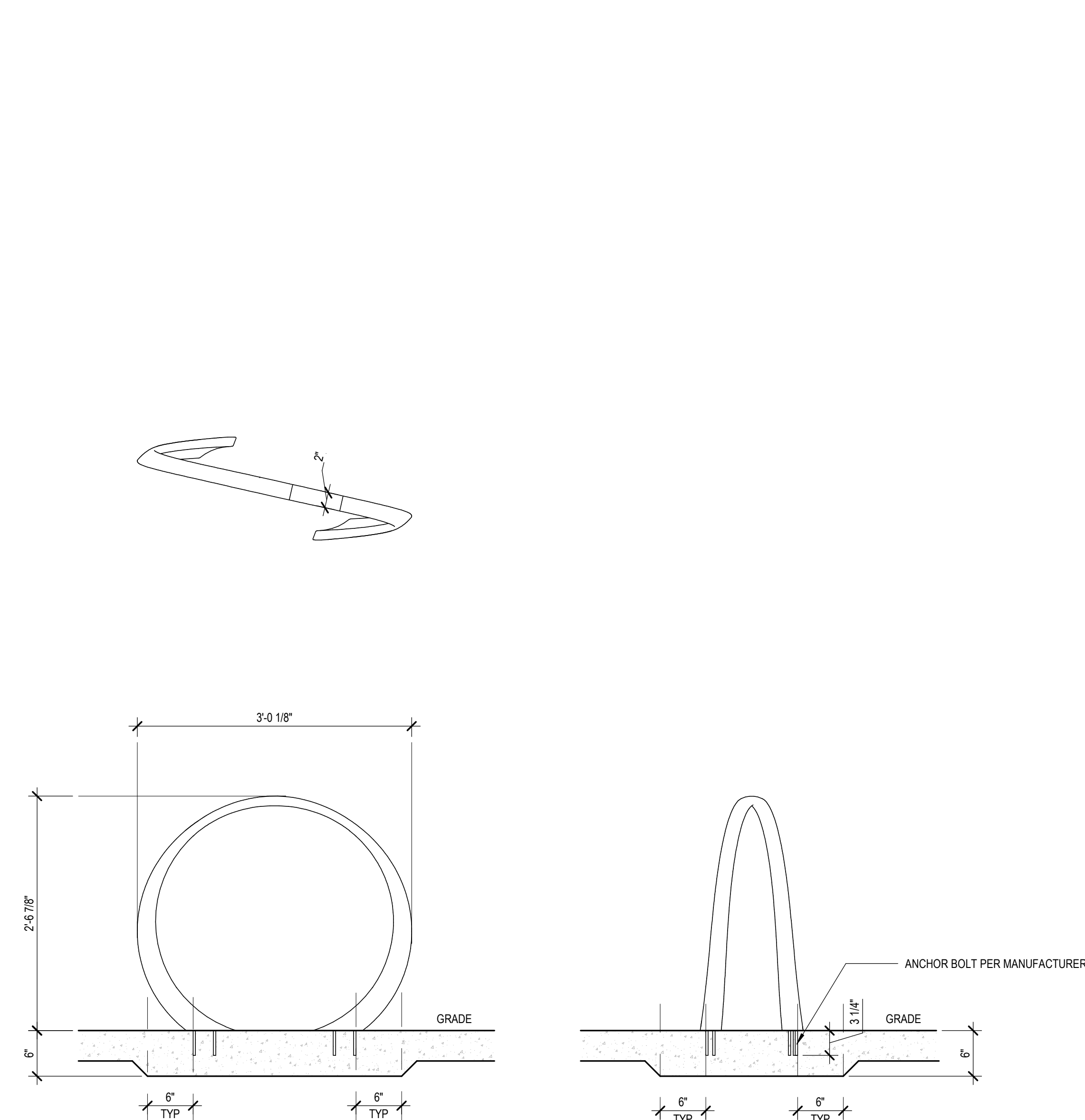

2 BIKE RACK (BR) - TOWER  
1" = 1'-0"

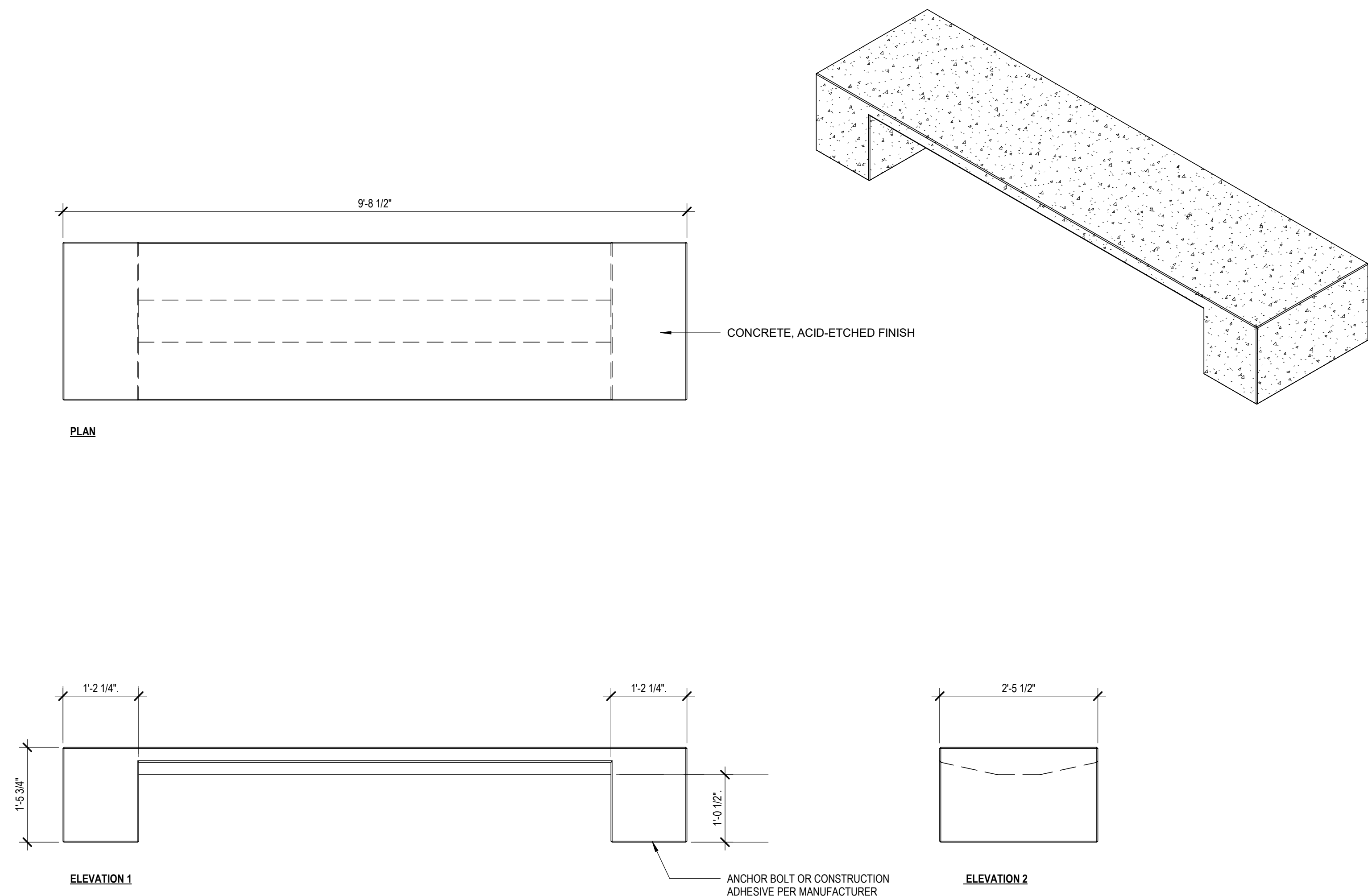

1 BENCH (BN) - TOWER  
3/4" = 1'-0"

No.	Revision Description	YYYY-MM-DD
1	MPP STAGE 2	2022-05-25
1	MPP STAGE 2 RESPONSE	2022-06-30
1	MPP STAGE 2 RESPONSE 2	2022-08-19

Agency Approval

Key Plan



Hellmuth, Obata + Kassabaum, Inc.  
One Bush Street, Suite 200  
San Francisco, CA 94104 USA  
t +1 415 243 0555 f +1 415 882 7763

All reproduction & intellectual property  
rights reserved © 2021

BKF ENGINEERS  
Civil Engineering  
880 9th St, Suite 2300  
Sacramento, CA 95814

Professional Seals

NOT FOR  
CONSTRUCTION

Facility  
KAISER PERMANENTE  
ROSEVILLE MEDICAL  
CENTER  
ROSEVILLE, CALIFORNIA

Project  
INPATIENT BED TOWER  
1600 EUREKA RD  
ROSEVILLE, CA 95661

Sheet Title  
MATERIAL & FURNISHING  
DETAILS

Scale:	Kaiser Project # CAP015954 HOK Project # 17.04047.00 Sheet Number
Date:	08/19/22

L4.12

Original drawing is 42 x 30. Do not scale contents of this drawing.